



NAYERA Dahabeya

NILE RIVER



NAYERA: 9 suites

NAYERA is a bespoke dahabiya (traditional Egyptian sailing boat), available for charter. With only nine suites,



Feel the Nile's pulse

Adventure, enchantment and 'Luxury, naturally' - all delivered with a quiet, understated charm and understanding of place – is the guiding philosophy of our luxury Nile cruise sailing boat, NAYERA dahabeya.

NAYERA is a bespoke dahabiya (traditional sailing boat) that is the first of its kind on the Nile; available for charter. With only nine suites, NAYERA offers you the unique opportunity to tailor your Egypt cruise and each day's sightseeing by offering an "a la carte" style and open buffet touring itinerary. Bask in the beauty of the surrounding views – unchanged for hundreds of years – as you sip on delicate cocktails from the comfort of the dahabiya. This is what sailing on the Nile was meant to be.

USPS

- Your itinerary can be personalised to suit your needs
- Exclusive docking area at Luxor and Aswan
- An authentic "dahabiya" (traditional Egyptian sailing boat) offering a completely bespoke service
- Available for charter, accommodating maximum 18 guests
- Perfect for celebrations and family groups

ACCOMMODATION AND FACILITIES

NAYERA features 9 beautifully designed Suites:

- 4 suites with double beds (28m²)
- 4 suites king bed (28m²)
- One suite full panoramic king bed (32m²)
- Salt cave(SIWA salt)
- Fitness area

The suites with double bed is inspired from the nature to sleep under the mountain with candle lights, the suites with king bed is inspired also from the nature to sleep under moon with candle light, All suites are fitted jacuzzi with luxurious amenities, Moroccan style bathrooms, showers ,air-conditioning with individual control, safe boxes , equipped with mini bar and 4K LED television (with information channel.) There is telephone access is available in suites. There is an auto wakeup call service for guests. An extra key is available upon request.

There is an upper deck, a luxurious Andalus themed sun deck with dipping pool (heated to 28 degrees during winter), dining area and lounge. A doctor can be called upon request, 24 hours a day. Laundry service and room service are available. There is a no smoking policy throughout the boat, except on the open decks and there is also a no mobile policy. A massage service is available to guests. Wheelchairs are available upon request on a complimentary basis, but if client requires staff assistance, an extra charge will be added. For safety on board: very sensitive fire alarm system, fire fighting team, emergency lights and signs, life jackets and exit plans behind cabins' doors.

LOCATION AND GETTING THERE

The seven night cruise departs from Luxor and sails to Aswan, before returning to Luxor again. We recommend flying from Cairo to Luxor directly.

Flying times:

- Cairo to Luxor - 1 hour

Transfer times:

- Luxor Airport to dock - 30 minutes



ITINERARIES

Our seven night cruise departs from Luxor and sails to Aswan, before returning to Luxor again.

The cruising itinerary for NAYERA dahabyea is unique in that it does not follow a specific itinerary with regular sites. This is a fully tailor-made affair, giving you a choice of the sites you would like to see during your Nile sailing experience.

Due to its small size, NAYERA dahabyea can dock more easily than a larger Nile cruise boat and so has the freedom to make the touring bespoke. There is the chance to see sites that are off the beaten track. One intriguing example the Valley of the Workers, was a self-contained village on the West Bank where the workmen who built the kings' and queens' tombs lived in mud brick houses with their families. The site gives archaeologists a view of how urban people lived in ancient Egypt. You can also visit the tombs that the workmen created for themselves, to admire the art in ordinary people's tombs.

ON-BOARD ACTIVITIES

Entertainment schedules during cruises are adjusted according to the needs of each group of guests and the exact sailing schedule.

However, every cruise on will include:

- A colourful "galabeya party" which gives each guest the opportunity to dress up in traditional Egyptian dress and dance to Arabic music.
- A lecture held by your Egyptologist guide.
- Cooking demonstration (Three Egyptian items)
- In-house movies

FAMILIES WITH CHILDREN

We welcome children of any age on NAYERA dahabyea.

An extra bed can be provided on request. Baby cots and baby chairs can be provided upon request. Children's menus are available at meal times.

HONEYMOONS AND SPECIAL OCCASIONS

Guests celebrating their honeymoon or a special occasion will receive special surprises during their stay.

Our honeymoon services include:

- Flowers and a romantic dinner (can be arranged upon prior request, at an extra charge)
- Heart shape cake and ceremony performed by staff (free of charge)



DINING

Breakfast, lunch, afternoon tea and dinner are included in your stay; as well as mineral water, tea, fresh juices and coffee during meals. Early riser tea and coffee service is available. International cuisine as well as local flavour ensure we cater to all tastes. Sumptuous buffets, elegant a la carte dinners and extensive local and international wine lists are all offered.

Meals typically consist of the following:

- Breakfast: American Buffet and a la carte Egyptian items
- Lunch: Buffet style (International, BBQ and Egyptian Buffets)
- Afternoon tea: (Selection of pastries, cookies and fresh fruits)
- Dinner: Buffet style (International, BBQ and Egyptian Buffets)

Our expert chefs can also cater to specific dietary needs of guests. Vegetarian and children's menus are available at meal times. Open doors meals (Breakfast, Tea, BBQ, Egyptian dinner) are served on the deck during sailing if the weather permits.

CLIMATE

Egypt has a hot dry climate. The temperatures are hot on summer days and warm on summer nights; warm or mild on winter days and cool on winter nights. The thin coastal strip at the north of Egypt has the most moderate temperatures, because of prevailing Mediterranean Sea winds.

- **Spring:** From May to August
- **Winter:** From November to March
- **Rainy:** From December to February

Temperatures:

- A minimum average of 9.5C (49.1 F) on winter nights
- 17C (63 F) on winter days
- Average minimum of 23C (73 F) on summer nights
- A maximum average of 38C (88 F) on summer days

Sometimes between March and May, a hot and dry sand storm, known as Khamasin winds, blows from the southwest. The best time to visit Egypt is from October through to April, as the weather is cooler.

CLOTHING

Dress code is free as the boat is available on a charter basis. Guests should pack cool and comfortable clothing.

Jerseys and heavier jackets are needed for spring and winter, light t-shirts and shorts can be worn during summer. Sturdy and comfortable shoes are essential.

Accessories to pack include: Camera; video recorder and cap or hat.



HEALTH

There is no requirement for vaccinations when travelling to Egypt (except for Yellow Fever if you are arriving from an infected area.)

MONEY AND CREDIT CARDS

Egyptian Pounds, Euros, UK pounds or US Dollars (2008 or newer) are accepted. Change given in local currency. We also accept travellers cheques, Visa, MasterCard and American Express.

TIPPING GUIDELINE

Tipping is not mandatory and is at the guests' discretion.

SPECIAL REQUESTS

NAYERA dahabyea prides itself on its personalised services. Please let us know if you have any special requests, interests, dietary requirements, allergies or medical conditions.

ENVIRONMENT & RESPONSIBLE TRAVEL

- The boat is fitted with a state of the art sewage disposal and water treatment system in order to recycle and purify all used water on the boat.
- NAYERA dahabeya has cleaned and made extensive alterations to one of the docking areas – transforming an informal rubbish dump into a small garden.
- The crew follows an extensive recycling programme on board, with all waste materials sent to specialised recycling centres to minimise impact on the local environment.



DECK PLAN

NAYERA DAHABEIA

NAYERA DAHABEIA DECK PLANS

 panoramic suite

 4+4 suites

 Gym & Spa

 Out Door Seating

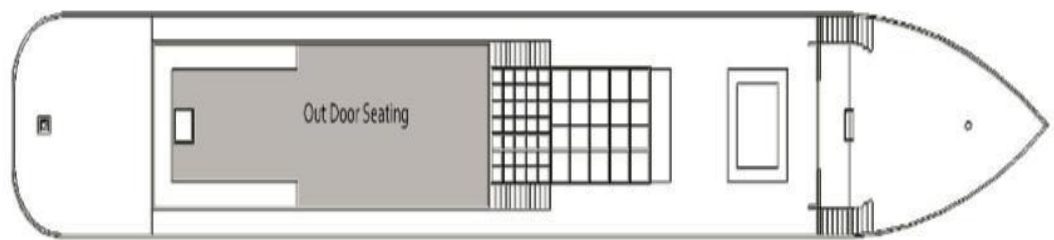

SUN DECK

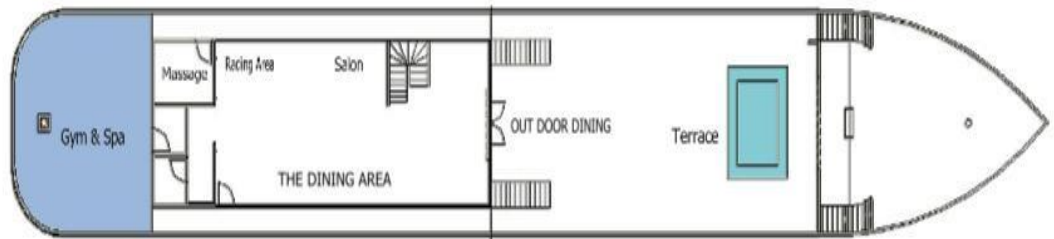

UPPER DECK

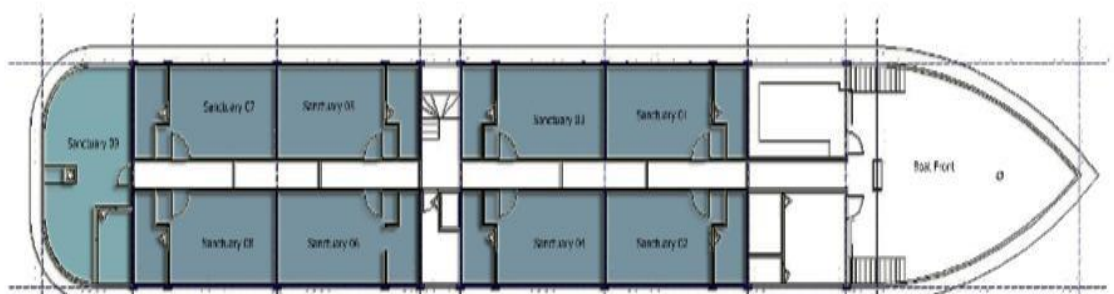

TECHNICAL INFORMATION

- Length: 52m
- width: 8.5 m
- Gross tonnage: 180
- Cruising speed: 6-8 km/hr
- Passenger decks: 3
- Life jackets: 2 in each cabin



NAYERA DAHABYEYA



Feel the Nile's pulse

NAYERA dahabeya was born in Egypt. We promise adventure, enchantment and to feel the Nile's pulse, all delivered with a quiet, understated charm and understanding of place.