

H

*Welcome aboard Historia.*

Evoking the spirits of yore, with the relevance of the modern day. Imagery of fluttering, cream linen curtains on an aged, wise deck; one with stories to tell and things that have been seen. Roving throngs of eager, curious tourists, marveling in the sensory delight of their surroundings; the majesty of ancient history, the lingering touch of the not-so-distant past and the undeniable influence of the enveloping present. Historia draws on elements of the unfamous boat's past, as well as a subtle nod to the roots and heritage of Egyptian culture. Communal lounges and dining rooms allow passengers to mingle and socialize, while also giving them the needed privacy for more relaxed experience.

هستوريا

SAIL THROUGH TIME





# Luxury Cabins

40 Cabins  
22 Square Metres  
Connected Cabins Available

Decorated with an elegant palette,  
each of our Luxury Cabins offer  
comfort and luxury, surrounded by  
the beauty of the River Nile with  
sweeping window views.

هستوريا

SAIL THROUGH TIME





# Historia Suites

8 Suites  
33 Square Metres  
Connected Cabins Available

Relax in an elegantly furnished suite that overlooks the Nile with scenic views, watch the River Nile come to life each morning from the comfort of your own private suite.

هستوريا

SAIL THROUGH TIME





# Presidential Suites

Two Suites  
40 Square Metres  
Connected Cabins Available

With a vibrant Nile View, the Presidential suites present unique Personalized amenities and stylish accommodation, equipped with state-of-the-art modern furnishings for your comfort and convenience.

هستوريا

SAIL THROUGH TIME





# Royal Suites

Two Suites  
46 Square Metres  
Panoramic Views

Inspired by Ancient Egyptian royalty, and designed for the most elegant sailing experience, the two Royal Suites are distinguished by their distinctive colour schemes and unique design filled with natural daylight and stunning views.

هستوريا

SAIL THROUGH TIME



# Cruise Facilities

Advanced ventilation system for a healthier  
indoor environment

24/7 Front Desk service

Restaurant

Lounge Bar

Sundeck Lounge & Bar

SPA – GYM

Room Service

Clinic / On Call Doctor

– Library

Bazar

Elevator

Free WiFi

Pets are not allowed at the cruise

Accessible Historia Suite available upon request

هستوريا

SAIL THROUGH TIME



# Cruise Facilities

## Smoking Policy

Smoking is only permitted on the Sundeck.  
All indoor cabins and facilities are non-smoking

## Children's Policy

Children under 4 years old, sharing a parent or guardians suite, will be free of charge.  
(Applicable for maximum one child)

Children aged 4-12 years old will be charged half the standard rate. (Applicable for maximum one child)

Children over 12 years of age will be charged the standard daily rate.

هستوريا

SAIL THROUGH TIME





# Cabin Facilities

Air Conditioning individually controlled

Mini Bar against Extra Charges

LCD Screen

Bathtub or Walk-In Shower

Hairdryer

Complementary tea & coffee making Facilities

coffee making machine

Safe Box

living area at royle suites

connected option upon request

Laundry service

Free WiFi

Telephone

Baby Cot available upon request

In room Dinning available upon request against extra charges

هستوریا

SAIL THROUGH TIME





# *The Solaria*



Take in the spectacular surrounding nature and soak in the sun rays aboard the Historia's Solaria deck. Enjoying the uninterrupted view from the luxury of the ship's own swimming pool is the perfect way to cool off after a day of exploring historical sites.





# *Nória Restaurant*

H

Designed to serve every table with magnificent view . Prepare for the day ahead with Historia dining experience which includes an extensive selection of hot and cold items with local, regional and international options.



The image shows a sophisticated lounge area. In the center is a dark, rectangular coffee table with a textured, perforated front panel. To the left, a teal armchair is partially visible, with a small side table holding a modern lamp. To the right, another teal armchair is shown, also with a side table. The background features a large window with sheer curtains, through which a city skyline is visible. The overall atmosphere is calm and elegant.

# *Aura Bar & Lounge*

Ⓜ

Relax and unwind at Aura Bar and Lounge while you watch The Nile flow by. The best way to unwind and let loose after a day filled with sun-soaked exploration is letting us serve you with fresh entertainment and refreshing cocktails.





## *Seneb Spa*

Enjoy, Relax and celebrate life with our extensive range of specialty treatments and services at our exclusive Historia Spa. Ease your mind and body, and simply unwind in this sweet escape. Our dedicated therapists are on hand throughout the journey, to provide you with a personalized unforgettable experience. Sail smoothly through time along the surrounding River banks and its sustainable, natural, elements to further connect and ground ourselves to the secrets of nature. Sailing through history, giving us a glimpse of how our ancestors used the many elements of life to enhance their overall well-being. Over 7000 years ago the Egyptian civilization used the word Seneb, which translates into “being healthy” or “to be healthy”. Our spa will help rejuvenate and create an up-lifting experience to guarantee a serene and unforgettable trip.

هستوريا

SAIL THROUGH TIME

## *Wellness Spa*





-  NORIA RESTAURANT
-  ELEVATOR
-  AURA BAR & LOUNGE
-  RECEPTION
-  LUXURY CABINES
-  HISTORIA SUITES
-  PRESIDENTIAL SUITES
-  ROYAL SUITES
-  SWIMMING POOL

SOLARIA SUN DECK

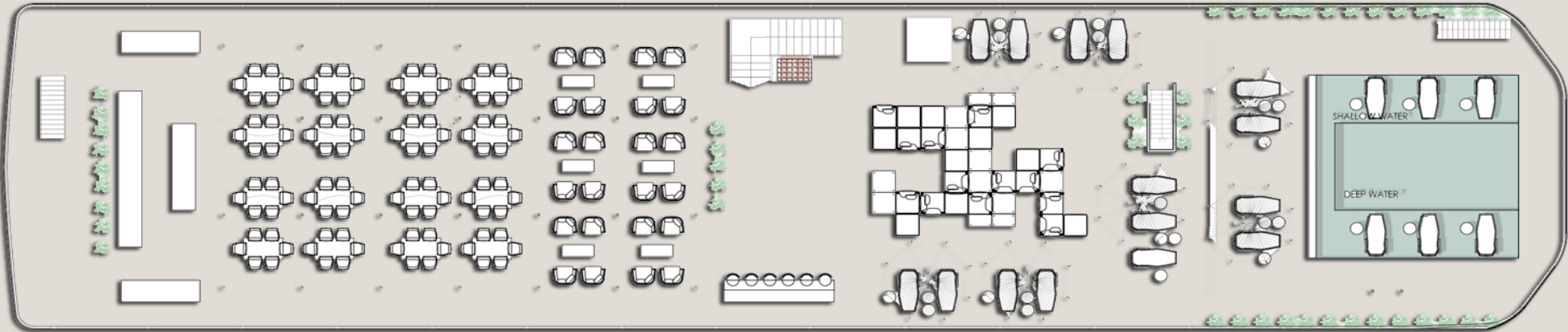

UPPER DECK

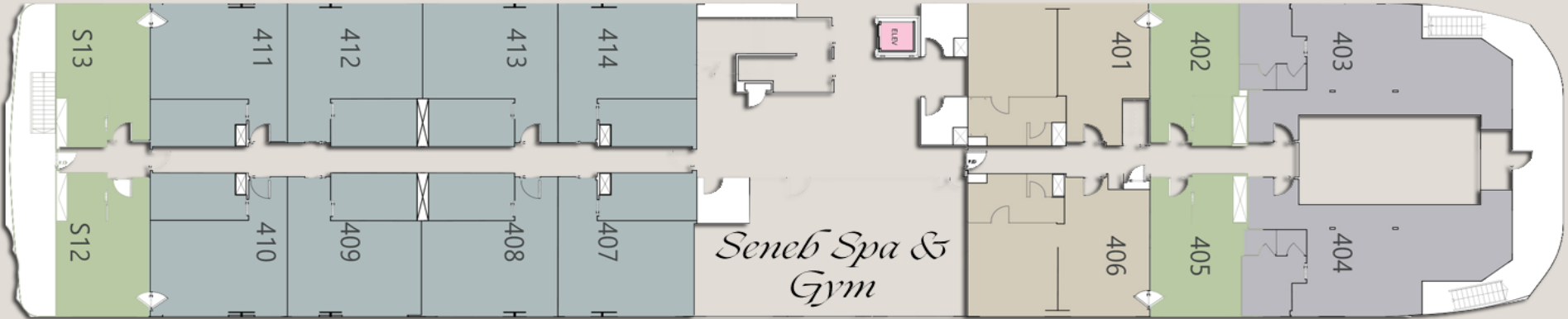

MIDDLE DECK

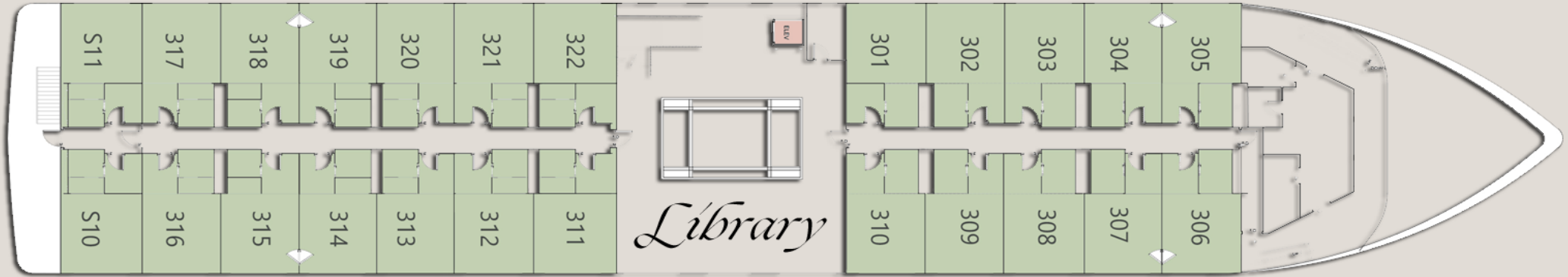

MAIN DECK

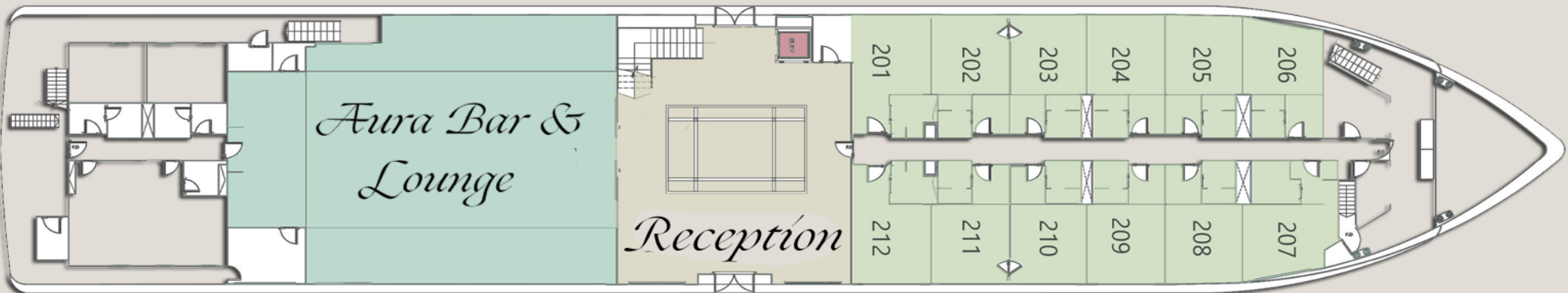

NILE DECK

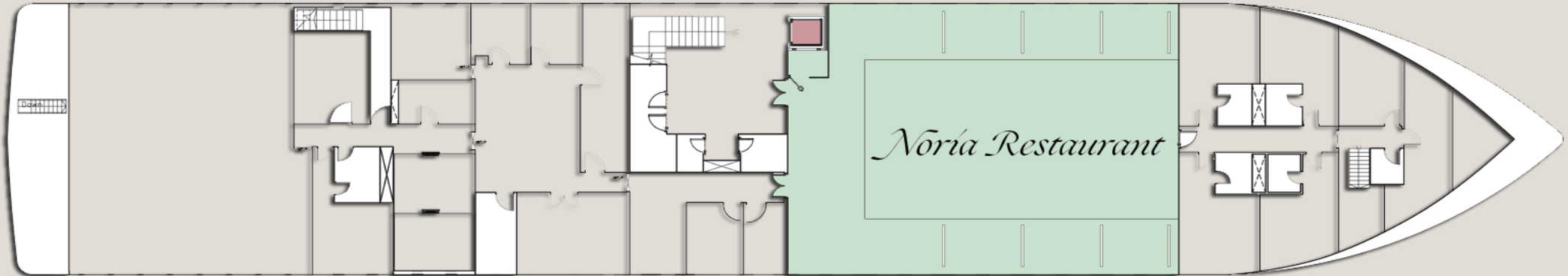





# LUXOR

Karnak Temple  
Luxor Temple  
Museum of Mummies  
Valley of the Kings  
Valley of the Queens  
Hatshepsut Temple  
Nefertari Tomb

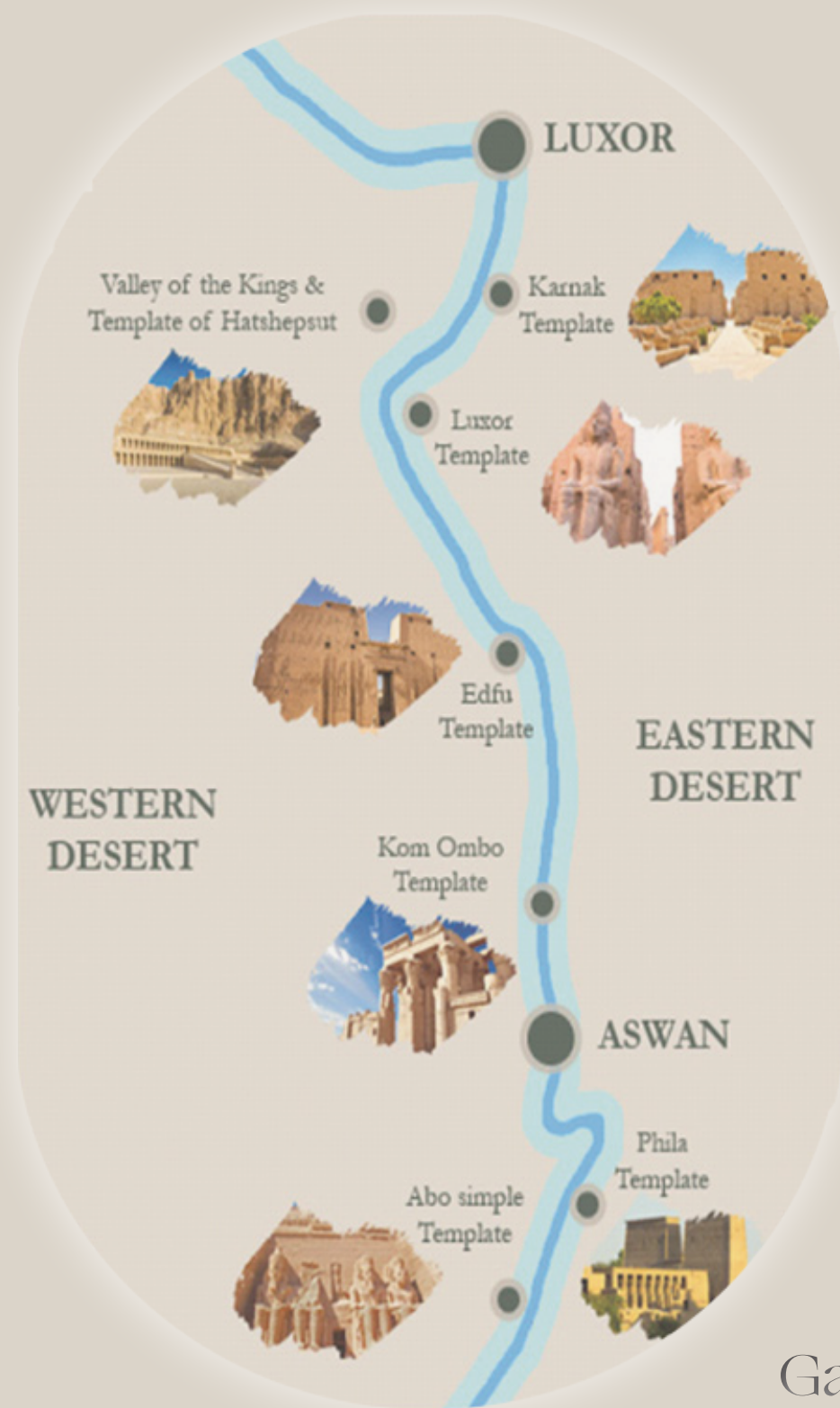

# ASWAN

Gate to Nubia and Africa  
Home of the Oldest Cataract  
The High Dam  
The Long-Forgotten Temple  
of Horus  
Philae Temple  
Kom Ombo Temple



هستوريا

SAIL THROUGH TIME





# SAIL THROUGH TIME

هستوریا

SAIL THROUGH TIME